



GE INDUSTRIAL MOTORS
a **WOLONG** company

Product Information Packet

July 3, 2020

Data shown is for the current revision model #. Ensure your nameplate model # matches.

Model Number:	5KFE103ZWL3097
Catalog Number:	--
Instruction Manual:	GEI-M1052-SP
Connection Diagram:	--
Outline Drawing:	358B6962AA

Accessory Connection Diagrams

Bearing Thermocouple:	None	Heater:	None
RTD:	None	Thermistor:	--
Thermostat:	None	Winding Thermocouple:	None
Bearing RTD:	None		

Table of Contents

Specification	01
Performance Characteristics	02
Outline Drawing	03
Connection Drawing(s)	04

Marks:

MODEL NUMBER:	5KFE103ZWL3097	Estimated Weight(kg):	36
Outline Drawing:	358B6962AA	Duty:	S1
Connection Diagram:	--	Enclosure:	TEFC
Connection:	DELTA / WYE	Encl Construction:	Energy Saver
Instruction Book:	GEI-M1052-SP	Cooling (IC):	411
Design Code:	NA	Protection (IP):	55
Type:	KFE	Ambient Max (°C):	40
Frame:	100L	Alt Ambient Max(°C):	--
Mounting (IM):	B3	Ambient Min(°C):	-15
Phases:	3	Insulation Class:	F
Poles:	6	IEC Design:	N
Output Power:	2HP/1.5kW	Nominal Efficiency (%):	IE2-79.8
RPM:	940	Guaranteed Efficiency (%):	76.8
Voltage(V):	230/400	Power Factor (%):	72
Hertz:	50	Bearing - DE:	6206/2Z C3
Amps - FL:	6.51/3.76	Bearing - ODE:	6205/2Z C3
Service Factor:	1.15	Vibration (mm/s) rms:	1.6
Alt Service Factor:	--		

Enclosure is Totally Enclosed Fan-Cooled

Stamped Nameplate Notes:**Additional Information:**

SUITABLE FOR DOL STARTING
 ROTATION: CW VIEWED FROM DE
 INVERTER DUTY PER IEC TS 60034-25, SECTION 18
 INVERTER RATED PWM 20:1 VARIABLE TORQUE, 1.0 SF



Performance Characteristic:

LOAD %	125.0	115.0	100.0	75.0	50.0	25.0	0.0
% EFF	79.40	80.28	81.27	81.86	80.39	72.72	0.00
% PF	80.31	79.16	76.58	69.20	56.40	35.86	20.02
AMPS	4.24	3.92	3.48	2.87	2.39	2.08	1.99

TORQUE(FL) N-m 15.0 TORQUE(LR)%FL 229 TORQUE(BD)%FL 242
 AMPS(LR 400V) 19.0 PF AT START 20.02%

Other Useful Information for Application:

Rotor Inertia (Kg-m ²) :	0.01293
Max load inertia (Kg-m ²):	0.92785
Load Type:	Square Torque/Speed Characteristic
Voltage:	100%
Number of starts per hour:	2 Cold or 1 Hot
Acceleration Time with maximum inertia (sec):	3.2
Safe stall time (sec): Cold/Hot	22.1/9.0

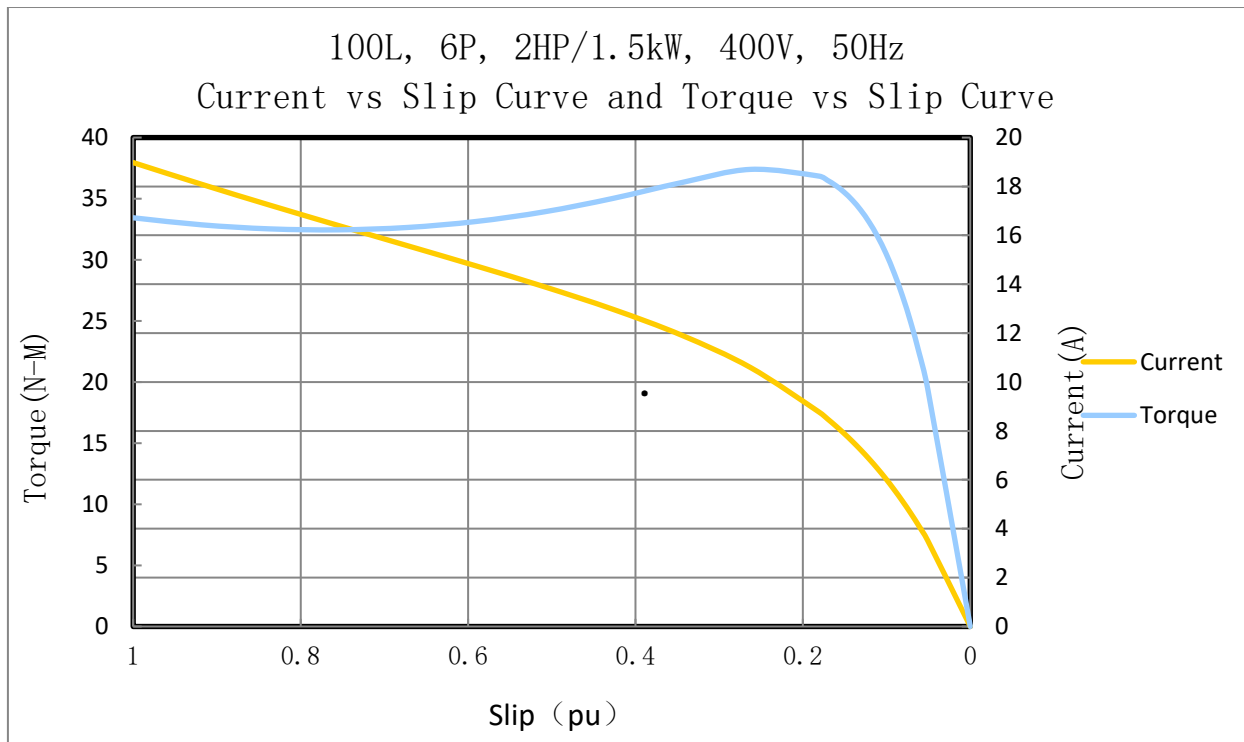

Marks:

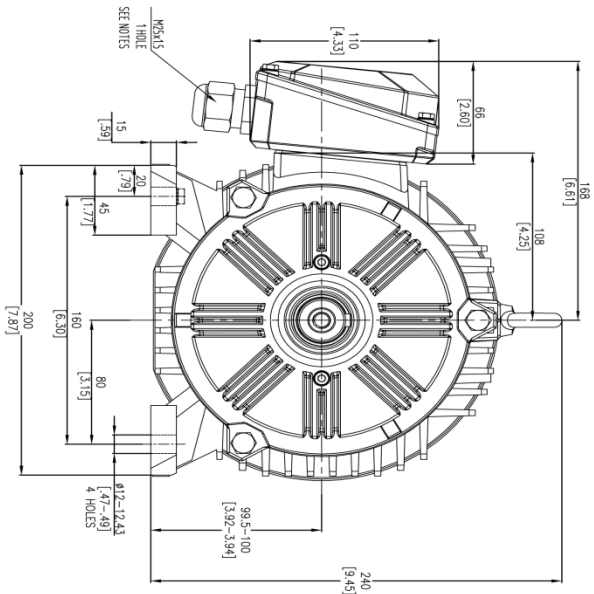
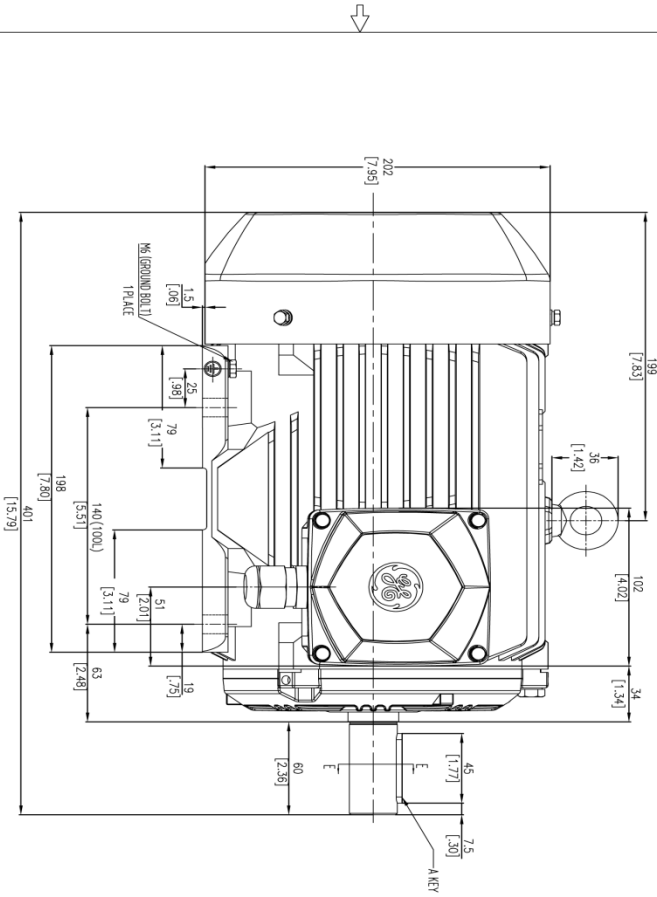
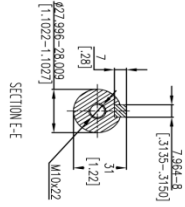

- NOTES
1. CONDUIT BOX IS SUITABLE FOR UP, DOWN OR EITHER SIDE ENTRY.
 2. ALL DIMENSIONS ARE IN MM BRACKETED DIMENSIONS ARE INCHES.
 3. IMB3 ASH AS SHOWN.
 4. THE GROUNDING POINT MARKED WITH THE GROUND SYMBOL MIGHT BE ON A DIFFERENT POSITION DUE TO A DIFFERENT VERSION OF THE DRAWING.

PROPRIETARY INFORMATION

© COPYRIGHT 2018 Wabing Electric America LLC AND/OR ITS AFFILIATES. All rights reserved. This document and the information it contains is the property of the Wabing Electric America LLC and/or its affiliates. It has been provided solely for private use. Copying, reproducing, selling, importing, exporting, displaying, transmitting or distributing this document and any of the information it contains is strictly prohibited. Wabing Electric America LLC is the Wabing Electric America LLC.

REV	DESCRIPTION	DATE	APPROVED
001	ISAC #20-0596 ALLEY	06/19/2020	SHMD

SIGNATURES	DATE
MODEL	-
DETAIL	ALLEY 07/08/19
CHECKED	SHMD 07/08/19
ENGRG	ALLEY 07/08/19
HFG	
QUALITY	
ISSUED	SHMD 07/08/19

GE INDUSTRIAL MOTORS
a Wabing company
 OUTLINE, IEC
 100L-2, 4, 6 B3 TEFC
 410 CU. CENTIMETER C/BDX
 358B6962AA
 SCALE: NA
 SHEET 1

REV 001